



EXTRALINK MYSTIC 4G PTZ SOLAR POWERED SECURITY CAMERA Model: ESC-S12-4G



V2.3

1:PRODUCTS & PACKING LIST

1.1 Product picture:



1.2 Packing list:

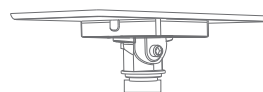

1* Solar panel



1* PTZ Camera

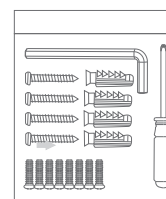

1*Screw kit

- 1*Hexagon spanner
- 1*Screw driver
- 8*Screws
- 4*Tapping screw
- 1* USB charging cable



1*User manual



1*Position paper



1*Qualification

- 1 -

Product Diagram

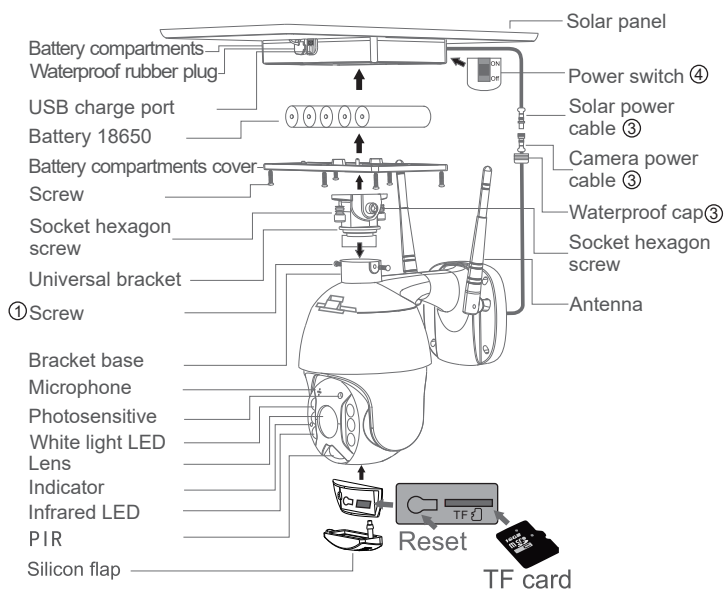

1.3 Process

- 1.3.1. Solar panel: connect panel to camera, fix a suitable angle with screws
- 1.3.2. SD card installation : open the silicon flap and insert the SD card, then make sure to close the silicon flap to avoid rain leakage
- 1.3.3. insert TF card , then tightening the screws.. Power cable: connect the cables between the panel and camera, then tightening the waterproof cap.
- 1.3.4. Panel power-on: Remove the rubber of panel,make sure it is power on. Then put the rubber back to the panel.

2 .INSTALLATION

2.1 Intergrated installation

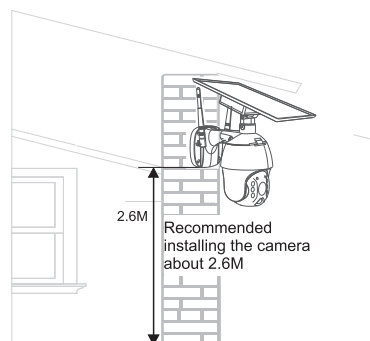

3. APP INSTALLATION

3.1 Search and download "tuya" in major application markets or scan the QR code below to download the APP.



3.1.1 Once you download the APP to your smart phone, you may enter the first page which you can Login with existing account or register.

(If you are the new user of Smart Life and don't have an account, please choose register first and follow the below screenshots to complete the registration.)

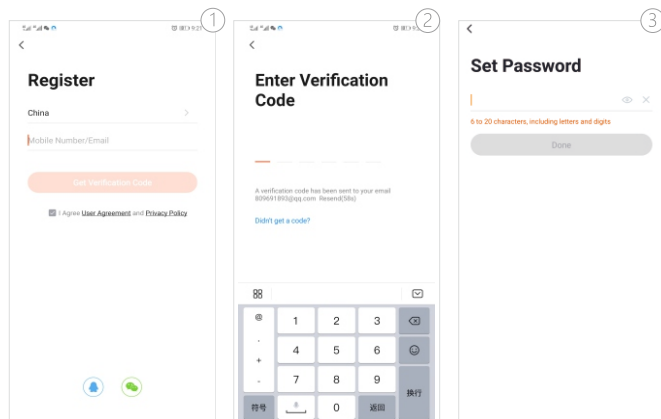
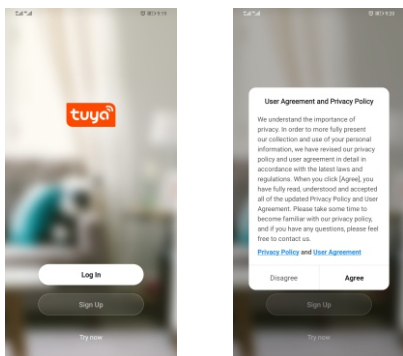

(If you have the existing account, there are two ways to login, one is with SMS verification Code, the other one is with password. In case you forget the password, you may choose login SMS verification Code or you can choose forgot password to reset it by Entering Verification Code which sent to you mobile via message.)

3.1.2 Once the account has been setup successfully, then you will automatically enter the page of "add device", kindly follow below steps to add the camera.

- 4 -

Step1:click "Add Device"or click "+" on top of right on this page

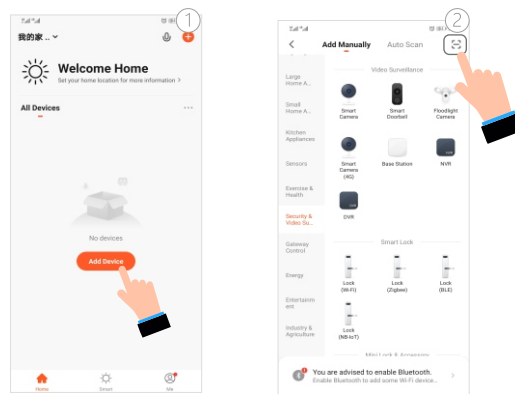

Step2: Scan the QR code on the camera with your mobile phone, and after successfully pairing, it will prompt "Added successfully"



- 5 -

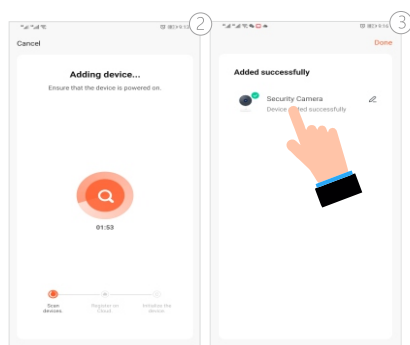

Step3. If you choose " the other mode " on the top of the right side, you may find QR Code Net-pairing Which you will go back to the "Add device" page and process it again like above procedure. Or you can choose "Smart configuration" and follow the below screenshots and after that you will see the device added successfully.

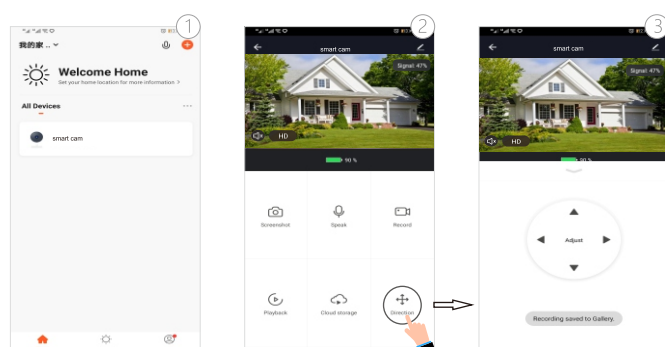

- 6 -

4.FAQ:

After the configuration is done, our device will be showed on Smart Life APP which enable you to surf the smart living easily. If you have any questions about App using, you may go to category "me" to find the " Help Center" and check if you have the same issues. If not, you can report the issue and then your problems will be handled and answers will be given soon if you provide as much information as you can.

5.Safe Battery Handling and Usage

DO NOT allow the batteries or battery compartment to get wet prior to or during installation while your Wire-Free camera is weatherproof and safe to use outside.

6. WEEE Disposal and Recycling Information:



All products bearing this symbol are waste electrical and electronic equipment (WEEE as in directive 2012/19/EU) which should not be mixed with unsorted household waste. Instead, you should protect human health and the environment by handing over your waste equipment to a designated collection point for the recycling of waste electrical and electronic equipment, appointed by the government or local authorities. Correct disposal and recycling will help prevent potential negative consequences to the environment and human health. Please contact the installer or local authorities for more information about the location as well as terms and conditions of such collection points.



EU Declaration of Conformity
Hereby, SHENZHEN RUIBOSI ELECTRONIC CO., LTD. declares that the radio equipment type ESC-S12-4G is in compliance with Directive 2014/53/EU.

Importer/responsible entity: BATNA Sp. z o.o., ul. Olgi Boznańskiej 3e, 42-202 Częstochowa

- 7 -